

ROTORUA DISTRICT COUNCIL
 BUILDING APPLICATION FORM

Received 22/7/85
 File Number 656/535/84
 Application No. 1301
 Date _____ 198__

I hereby apply for permission to erect, repair, alter, extend a building at No. 462 PUKEHANGI
ROAD ROTORUA for
 (Address)

Mr/Mrs G. A & A. J. MCCALMAN of 462 PUKEHANGI ROAD ROTORUA
 (Owner) (Address)

according to locality plan and detailed plans, elevations, cross sections, and specification of building deposited herewith in DUPLICATE (see reverse side).

PARTICULARS OF LAND

Lot No. 4 D.P. No. 24208
 Area: _____ Zoning: _____

PARTICULARS OF USE OF BUILDINGS

Proposed purpose for which every part of building is to be used or occupied (describing separately each part intended for use or occupation for a separate purpose, i.e., shop, factory, dwelling, office, carport, etc.)

USE CARPORT ~~DECKING~~

Area of ground floor _____ Estimated value:
 Gross floor area _____ Building work \$ 2100.00
 Area of accessory buildings _____ Plumbing & Drainage \$ —

Builder's name FAIRMONT DEVELOPMENTS LTD Total \$ 2100.00
 (Please Print) Signature of Applicant G. McCalman

Address P.O. Box 2243 ROTORUA Address 462 Pukehanga Road, Rot.

Phone No. 83661 Phone No. 81345

FOR OFFICE USE ONLY

Application checked and approved by:
 Building Inspector _____ Health Inspector BC
 Date 12/8/85 Date 7/8/85
 Town Planning Officer _____ Dangerous Goods Inspector BC
 Date 12-8-85 Date 7/8/85
 Plumbing & Drainage Insp. Ray E Geothermal Inspector BC
 Date 7/8/85 Date 7/8/85
 Structural Engineer _____ General Inspector HRD
 Date _____ Date 7/8/85

Issue of Permit Approved

 Engineer
 Date 12-8-85

SUBJECT	APPLN No.	PERMIT No.	DATE	VALUE	FEE
Building		<u>60 72520</u>		\$ <u>2100</u>	\$ <u>30.00</u>
Plumbing				\$	\$
Drainage				\$	\$
Water Connection				\$	\$
Damage Deposit				\$	\$
Vehicle Crossing				\$	\$
Sewer Connection				\$	\$
Stormwater Disconnection				\$	\$
Water Disconnection				\$	\$
Building Research Levy				\$	\$

(See scale of fees and general information on back)

Date 12-8-85
 Receipt No. 9

TOTAL: \$ 130.00

FEE PAYABLE ON THE ISSUE OF ANY BUILDING PERMIT

according to the Estimated Value of Work

Estimated Value of Work	Fees
Not exceeding \$800	— \$15.00
Over \$800 and not exceeding \$1,600	— \$20.00
Over \$1,600 and not exceeding \$1,800	— \$25.00
Over \$1,800 and not exceeding \$2,000	— \$27.00
Over \$2,000 and not exceeding \$2,500	— \$30.00
Over \$2,500 and not exceeding \$3,000	— \$33.00
Over \$3,000 and not exceeding \$3,500	— \$36.00
Over \$3,500 and not exceeding \$4,000	— \$39.00
Over \$4,000 and not exceeding \$5,000	— \$43.00
Over \$5,000 and not exceeding \$6,000	— \$47.00
Over \$6,000 and not exceeding \$7,000	— \$52.00
Over \$7,000 and not exceeding \$8,000	— \$57.00
Over \$8,000 and not exceeding \$9,000	— \$62.00
Over \$9,000 and not exceeding \$10,000	— \$67.00
Over \$10,000 and not exceeding \$12,000	— \$72.00
Over \$12,000 and not exceeding \$14,000	— \$78.00
Over \$14,000 and not exceeding \$16,000	— \$85.00
Over \$16,000 and not exceeding \$18,000	— \$95.00
Over \$18,000 and not exceeding \$20,000	— \$104.00
Over \$20,000 and not exceeding \$25,000	— \$124.00
Over \$25,000 and not exceeding \$30,000	— \$145.00
Over \$30,000 and not exceeding \$35,000	— \$165.00
Over \$35,000 and not exceeding \$40,000	— \$186.00
Over \$40,000 and not exceeding \$50,000	— \$214.00
Over \$50,000 and not exceeding \$60,000	— \$241.00
Over \$60,000 and not exceeding \$70,000	— \$269.00
Over \$70,000 and not exceeding \$80,000	— \$296.00
Over \$80,000 and not exceeding \$90,000	— \$324.00
Over \$90,000 and not exceeding \$100,000	— \$351.00
Over \$100,000 and not exceeding \$120,000	— \$379.00
Over \$120,000 and not exceeding \$140,000	— \$406.00
Over \$140,000 and not exceeding \$160,000	— \$434.00
Over \$160,000 and not exceeding \$180,000	— \$461.00
Over \$180,000 and not exceeding \$200,000	— \$489.00
Over \$200,000 and not exceeding \$240,000	— \$544.00
Over \$240,000 and not exceeding \$280,000	— \$599.00
For every \$40,000 or part thereof in excess of \$280,000 an additional fee of	— \$28.00

NOTE—The permit fee for the installation of free-standing fire places, pot belly stoves, or log fires is **\$12.00**.

BUILDING RESEARCH LEVY

A building research levy based upon \$1 per \$1,000 or part thereof of total permit value requires to be paid. Permits of a lesser value than \$3,000 are exempt from this levy.

IMPORTANT

PLANS AND SPECIFICATIONS

All builders should be conversant with the Building Bylaws wherein the requirements regarding drawings are stipulated.

Any applications not complying will not be accepted.

It is an offence to start building work before a permit is issued.

All plans must be drawn in metric to scale.

SITING OF BUILDINGS

It shall be the responsibility of the Owner of the land and the Builder to ensure that siting of all buildings conforms with the requirements of the District Planning Scheme and the Building Bylaws.

DAMAGE DEPOSIT

The amount of the damage deposit referred to overleaf is necessary to ensure that the value of any damage that is caused to public property during construction operations is recovered from the main contractor, or applicant, as the case may be. The amount is to be regarded purely as a deposit and will be refunded or adjusted upon application at the completion of the work.

SEWER CONNECTIONS

Applicants are reminded of their responsibility to have regard to the levels of Council's drainage services before construction of a building commences. Service levels can be obtained from the District Engineer's Office, Depot Street. Failure to do so may result in plumbing alterations or pumping being required.

DEVELOPMENT CONTRIBUTIONS

If you are contemplating a residential development which comprises 3 or more new units, or 2 or more additional units, or an industrial or commercial development, the value of which exceeds \$100,000, you will be liable to make a development contribution to the Rotorua District Council. If your proposal comes within this levy you are advised to contact the District Town Planning Department for further information.

LOT 4

D.P.S. 24208

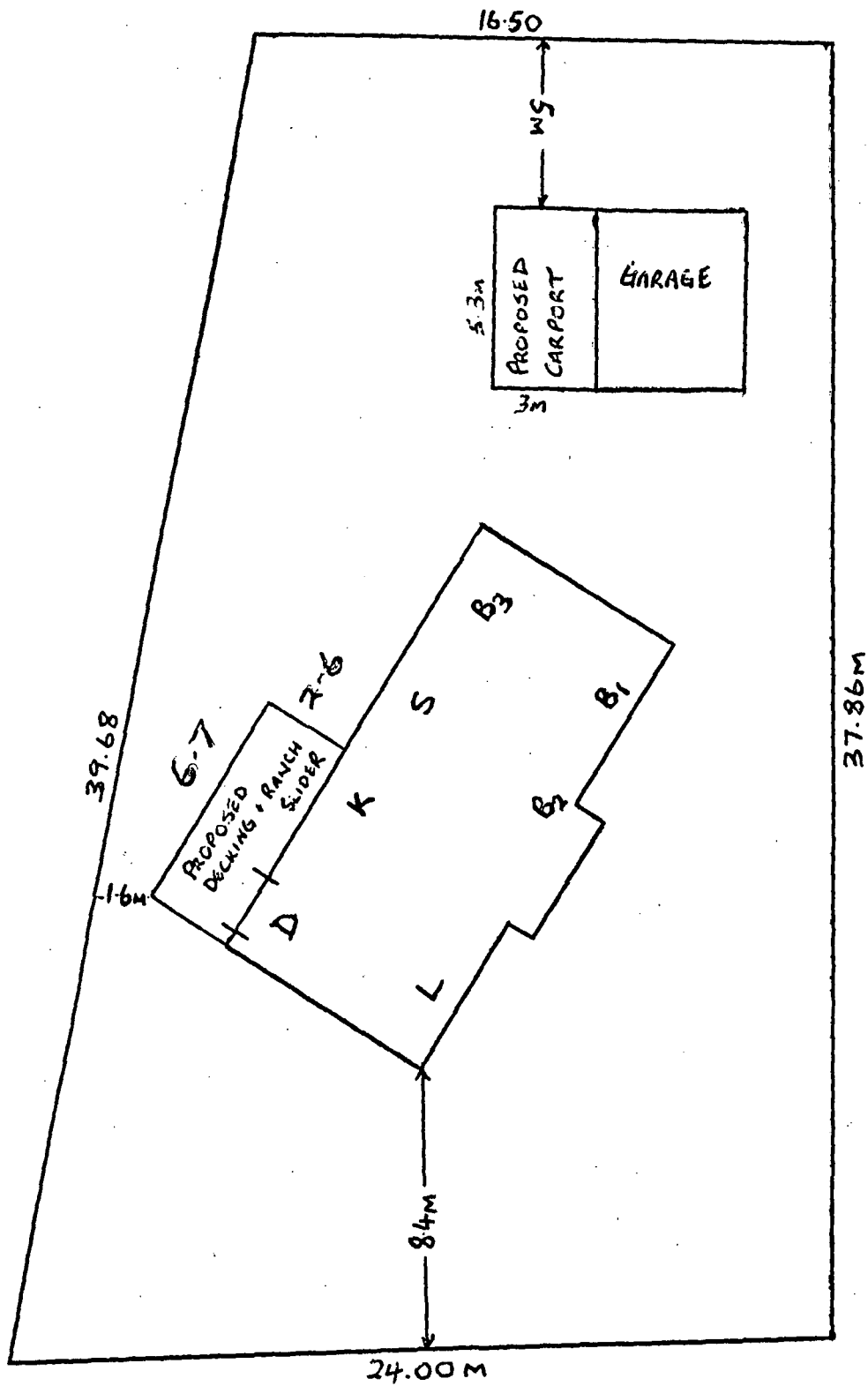

DECK CROSS SECTION
1:50

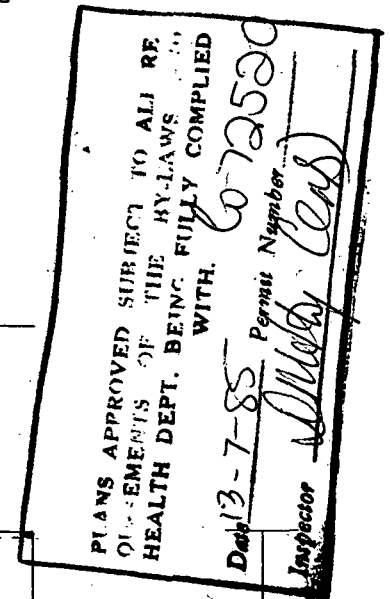
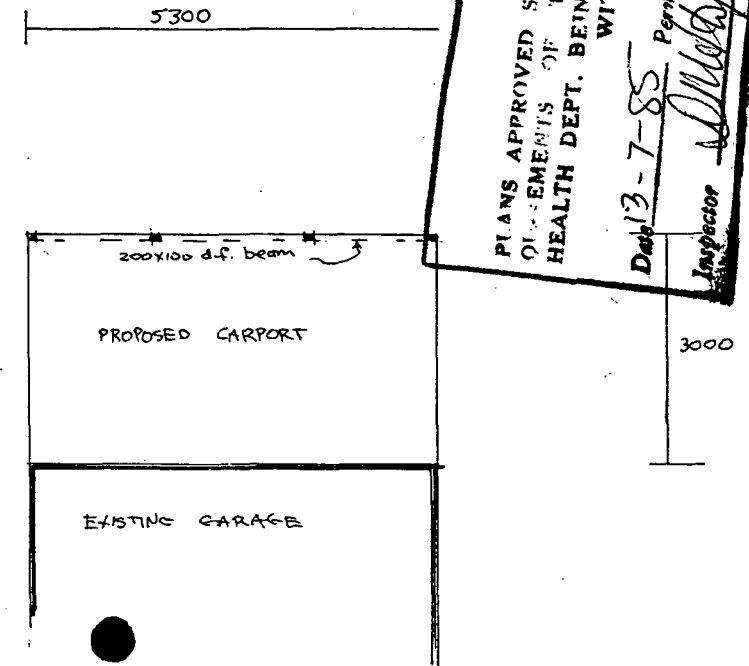
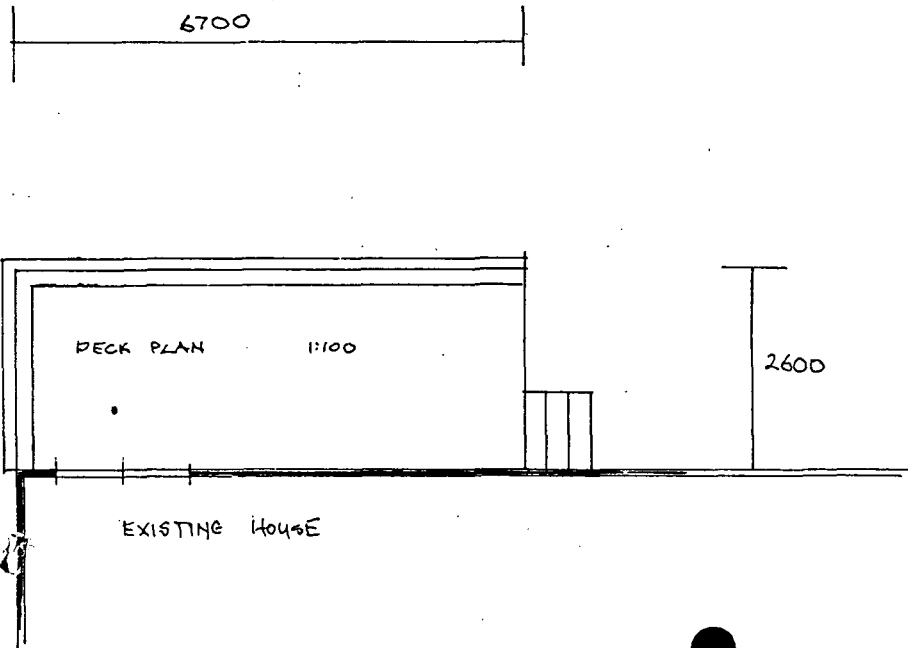
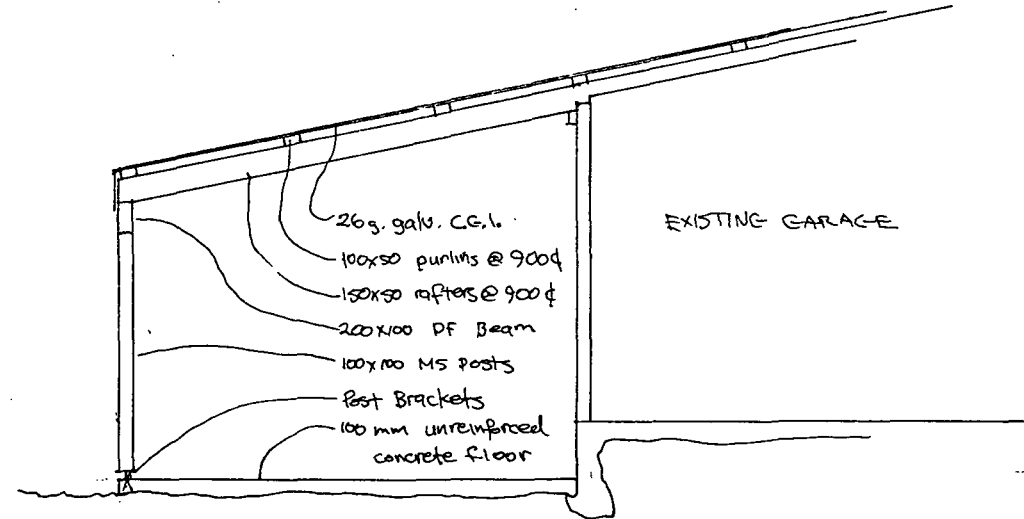
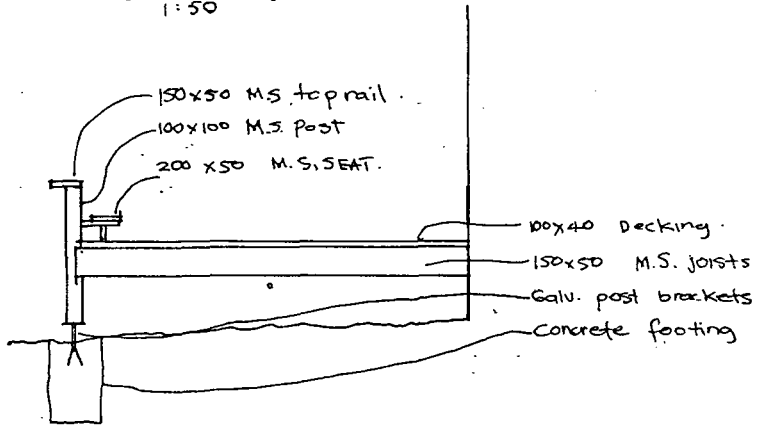

9 August 1985

G.A. & A.J. McCalman
462 Pukehangi Road
ROTORUA

Dear Sir

PROPOSED CARPORT & DECKING
LOT 4 - DPS 24208
462 PUKEHANGI ROAD

Receipt of your application for the above is acknowledged. Perusal of the plans and specifications has raised the following points which are hereby drawn to your attention.

1. Town Planning:

If siting of existing dwelling is as shown in this permit, neighbour's consent will be required for encroachment into the side yard.

2. Building Bylaw:

Please confirm that exposed timbers to the deck and carport will be treated or equal to tan 67.

B. Structural:

Please show the spacing of the joists supporting the deck.

Receipt of your advice in respect of the above matters will enable your application to be more fully considered.

Yours faithfully
D.J. McArtney
SENIOR BUILDING INSPECTOR

Per: B.E. Turner
BUILDING INSPECTOR

GA & AJ McAlman
462 Pukehang Road
Rotorua

File No. 656/535/34

Appn. No. 1301

Dear Sir

PROPOSED Carport & Decking LOT 4 SEC. BLOCK D.P.S. 24208
NO. 462 STREET. Pukehang Road

Receipt of your application for the above is acknowledged. Perusal of the plans and specifications has raised the following points which are hereby drawn to your attention.

1. T.P.

If siting of existing dwelling is as shown in this permit, neighbour's consent will be required for encroachment into the side yard.

Building Bylaw

Please confirm that exposed timbers to the deck and carport will be treated or equal to tan C 7.

Receipt of your advice in respect of the above matters will enable your application to be more fully considered.

Yours faithfully

D.J. McArtney
SENIOR BUILDING INSPECTOR.

RN
DE Ten

APPLICATION NO. 1301

DATE RECEIVED 24/7
(DEPOT STREET)

	Date	Initials
Site Plan Draughting	26.7.85	Am.
Engineering (Design)		
Engineering (Sewerage/Stormwater)	5.8.85	Am.
Engineering (Water)	6.8.85	Am.
Returned to Amohau Street	6/8	Am.

Perusal of the plans and specifications has raised the following points :

Final siting needs verifying Am.

Structural.

Please show the spacing of the
joist supporting the deck

Am.

31/7/85

NOTE: Please briefly describe the problem so the applicant can be advised by letter. It is suggested that the applicant be advised to make contact with a party Officer to discuss the fault and remedy.

Inspector M

File No.

Receipt No. 9

Date Permit Issued 13/8/85

OWNER

Name CA & AJ McCalman

Mailing Address 462 Pukehongi Rd
Rotorua

BUILDER

Name Fairmont Developments

Mailing Address PO Box 2243
Rotorua

PROPERTY ON WHICH BUILDING IS TO BE ERECTED/DEMOLISHED

SITE

Street No.

Street Name A/A

Town/District

Riding

LEGAL DESCRIPTION

Valuation Roll No. 656/535/84

Lot 4 D.P. 24208

Section Block

Survey District

DESCRIPTION OF PROPOSED WORK AND MAIN PURPOSE OF USE

Carport

FLOOR AREA Whole Sq. Metres **DWELLING UNITS** Number Erected

ESTIMATED VALUES

Building	2,100
Plumbing	
Drainage	
TOTAL	2,100

NATURE OF PERMIT (TICK BOX)

☐ NEW BUILDING
- exclude domestic garages and domestic outbuildings

☐ FOUNDATIONS ONLY

☒ ALTERED, REPAIRED, EXTENDED
- include conversions and resited buildings

☐ NEW CONSTRUCTION
OTHER THAN BUILDINGS - include demolitions

☐ DOMESTIC GARAGES
AND DOMESTIC OUTBUILDINGS

FEES APPLICABLE

Building Permit	\$ 30	Water Connection	\$	Receipt No. 9
Street Damage Deposit	\$ 100	Vehicle Crossing Levy	\$	Date of Payment 12/8/85
Building Research Levy	\$	M.S. Plumbing	\$	Authorised Officer
Plumbing	\$		\$	
Drainage	\$		\$	
Sewer Connection	\$	TOTAL:	\$ 130	

Special Conditions:

Date Inspected

REMARKS (e.g. stage reached with work)

22-1-87

No inspections called for

CANCELLED

[illegible]

CANCELLED

Date / /